



MODEL 40

PRECISION FLAT LAPPING MACHINE



Integral abrasive dispenser



Integral waste tank

- The Lapmaster Model 40 machine is an up-rated version of the Model 36, with a larger diameter lap plate and support plate and correspondingly larger conditioning rings.
- All cast iron used for lap plates and conditioning rings is of the grey type and artificially aged by heat treatment prior to machining.
- The lap plate drive system uses a separate motor and worm- and wheel reduction gearbox with multi belt drive and is mounted in a substantial floor-standing base. The base is fabricated from welded hollow-section steel, clad with removable panels for maintenance. The electrical controls are housed in a console mounted at the front of the machine, and a second emergency stop button is fitted at the rear of the machine.
- The machine uses a free-abrasive slurry made from a Lapmaster abrasive powder such as silicon carbide, boron carbide or aluminium oxide, suspended in a suitable Lapmaster oil or water based vehicle. A diamond slurry dispensing system can also be fitted if required.
- Each Lapmaster Model 40 Openface flat lapping machine comes with integral stainless steel abrasive tank and pump system and an integral steel waste tank.
- As with all Lapmaster flatlapping machines, provision is made for lateral adjustment of the conditioning ring position, relative to the lap plate track, so that the plate-flatness can be finely controlled.
- This machine is also available in pneumatic lift version. See appropriate data sheet.



MODEL 40 STANDARD FEATURES

- Heavy duty, tubular steel, floorstanding base with integrally mounted drive motor, reduction gearbox, abrasive storage, abrasive distribution system, complete with control panel.
- Heavy Duty work table, vertically adjustable. Three conditioning rings, with adjustable roller-bearing yoke assemblies to maintain lap flatness.
- Abrasive system, complete with pump, agitator tank and multiple point distribution.
- Electrical system wired for 230/460V 60Hz, 3 phase with operator controls at 110V. NEMA Type 12 enclosure, complies with JIC standards.
- Operator control panel with start and stop controls and multiple range automatic cycle timer.
- High torque drive unit consisting of 4.0kW/5.5hp motor and heavy duty reduction gearbox. Lap plate speed 58rpm.
- Removable waste container.

STANDARD TOOLING

- Cast iron serrated lapping plate
1016mm O/D X 210mm I/D
40" O/D X 8 1/4" I/D
Wear life 32mm (1 1/4")
- Three cast iron serrated conditioning rings. 466mm O/D X 406 I/D.
16.5" O/D X 16" I/D.
Wear life 70mm (2 3/4")
- Three workholder blanks.
- Three felt pads.
- Starter sample of Lapmaster Abrasive.
- Starter sample of Lapmaster Vehicle.
- Lap plate lifting tool.
- Set of Allen keys.
- Operation and Maintenance Manual.

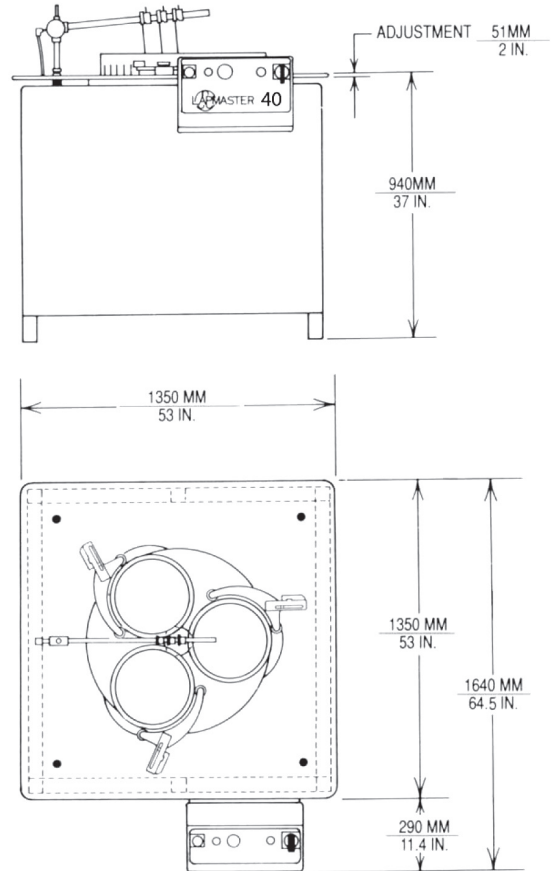

Packing Specifications
 Weight: 1400 kg/3088 lbs.
 Export packed in one wooden crate:
 2085mm x 1600mm x 2000mm
 Gross weight: 1880 kg/4145 lbs.

AVAILABLE OPTIONS

- 4 ring model.
- Variable speed lap drive (using frequency inverter).
- Water cooled lap plates.
- Non-standard voltages.
- Custom machines and tooling.
- Enlarged, moveable work table to improve multiple parts handling.



Lapmaster International
 6400 West Oakton Street
 Morton Grove, IL 60053 U.S.A.
 telephone 847.967.2975
 fax 847.967.3903
 toll free 877.352.8637
 web www.lapmaster.com

Lapmaster has a policy of continued development and the specifications outlined above are subject to change without notice.